



# TUNE 4

---

Quick Start Guide



# INTRODUCTION

Congratulations on your purchase of XTZ product. We at XTZ are very grateful that you have chosen one of our products, as it keeps us to continue creating and deliver what we love, "great experiences" through sound. We also want that as many as possible are able to afford these experiences, hence keeping the cost down on our products by keeping to things we know matters in sound reproduction. Through hours of listening tests and specialized measurements we are able to distinguish what technologies are the most efficient.

## TUNE 4

**TUNE 4** is an active compact speaker with focus on performance and convenience. To achieve this, the amplifier had to be built into the speaker itself, making TUNE 4 not only more compact but a lot less elements to manage. Further the amplifier has everything you need built in. Analogue input to really make it universal to all kinds of music sources but also optical input to connect your music device direct to the heart of the electronics. However cords can be a hassle, specially when you move around with your music source, to ease this the TUNE 4 speaker rocks the latest Bluetooth™ 4.0 with AptX technology, making your wireless streaming versatile yet maintain CD-quality.

Performance-wise the TUNE 4 speaker has several technical benefits:

**Off-center Tweeter** divide edge dispersion, creates a more even frequency response.

**Sturdy Cabinet** The cabinet is made out of extra thick MDF, keeping resonance low and a maximizes dynamic sound.

**Wave Guide** More controlled dispersion and raising efficiency, lowering distortion.

**High Stiffness/Weight Woofer Cone** Increased transient response, clearer vocals and spacious sound stage.

**Power Efficient** Modern technology, designed to use less energy yet provide high musical power.

**High Quality Components** TUNE 4 uses electronic and mechanical components of high quality to maintain a great build quality that last over the decades to come.

**Driver Alignment With Two Position** TUNE 4 is a very versatile speaker and should be able to be placed everywhere you can imagine, the cabinet is designed to align the drivers when used for a desk, however with supplied spikes it is possible for a vertical position for e.g. a bookshelf.

**Built-in Transformer** to keep the design as minimalistic as possible, no external boxes to manage.

## HOW TO CONNECT

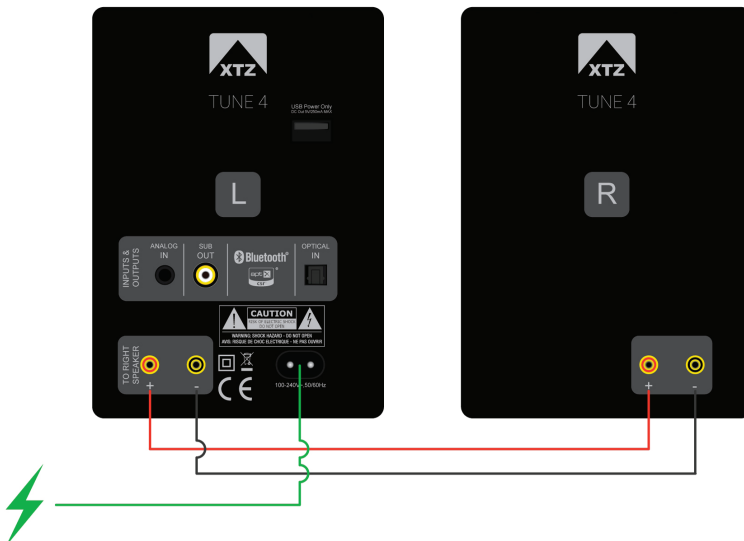

# CONNECTIVITY

The TUNE 4 speakers are designed for usability, being able to be used as easy as possible, either you can connect the music stream through the supplied cord to being able to play music right out of the box or set it up with a wireless bluetooth device of your choice.

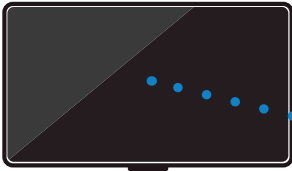

**TELEVISION** Use your TUNE 4 to gain a better experience out of you TV. Enjoy you favorite movies and series with high fidelity sound.

## TUNE 4



**COMPUTER** The TUNE 4 works perfectly with your PC or MAC, with its tilting positions upwards the drivers are aligned providing a optimized frequency response for the near-field listening position.



**PHONE** Your mobile phone is a perfect mate with the TUNE 4 as it provides you with wireless music stream through it its bluetooth capability.



**TABLETS** portable & wireless with perfect user interface for controlling your music streaming services.



**HIFI** Use your high quality radio, CD, music library or LP with the TUNE 4.



# ENHANCED EXPERIENCE

By connecting the TUNE 4 speakers to a well designed subwoofer, the potential are multiplied. The XTZ SUB 17-Series is a perfect match as it is the ultimate tool for deep bass and adapting to all kinds of rooms, it is also easy to connect as it only need one cord. The subwoofer output of the TUNE4 contains a sum of left and right channels, providing deep bass for both channels.

# REMOTE

The TUNE 4 is provided with a aluminum remote control, CNC milled from a solid block of aluminum. The remote lets you have control of all the TUNE 4 features wirelessly.

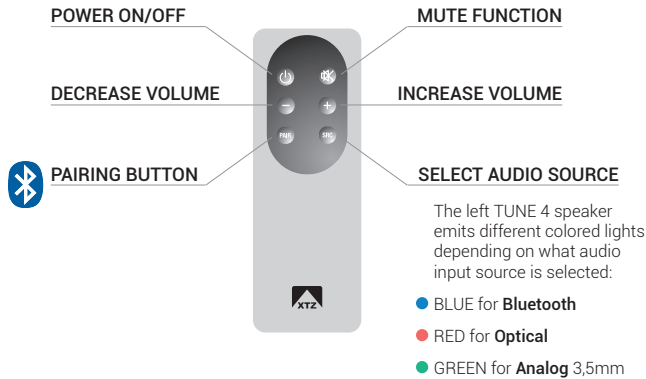

## Bluetooth™

How to connect you bluetooth device with the TUNE 4.

- 1** Activate Bluetooth on your music streaming device.  
(Computer, Phone or Tablet)
- 2** Make sure the bluetooth mode is activated on the TUNE 4 speakers.  
Use "SRC"-button to change source, the Left speaker's front-LED should emit blue light.
- 3** Press the "PAIR" button on the TUNE 4 remote control, "XTZ TUNE4" should now show up in your bluetooth device pairing options (Blue diode are rapidly flashing blue light).  
Accept the pairing and when the blue light has a stable blue light you are ready to enjoy your wireless music!

**Further information** The bluetooth range is about 10m with clear line of sight, if the TUNE 4 speaker will loose its connection with a bluetooth device due to low signal strength it will automatically reconnect when the device is present again. The TUNE 4 can remember up to 6 Bluetooth devices, and are always auto-connecting to the last used device when bluetooth mode is active.



The aptX® audio coding algorithm originated in the late 1980s at Queen's University Belfast. This innovative work was focused on bit rate reduction and achieved significant bit rate efficiencies while preserving audio quality.

aptX® has been the best kept secret of the professional audio industry, used by major public broadcasters and film studios around the world. Now available on leading consumer devices, aptX® enables music lovers to enjoy the rich listening experience that aptX® delivers. AptX offers CD quality through wireless bluetooth streaming, hassle free.

# ROOM TUNING

No speaker sounds the same in every room and all people have different taste in sound. This is why TUNE 4 comes with room tuning options to drastically alter the sound character of the speaker so it fits your needs. The tuning options allows you to adjust between sealed and room tuning enclosure. This is done with the supplied bass plug. A sealed enclosure will give you a more exact & distinct sound while the bass reflex enclosure will be more powerful.

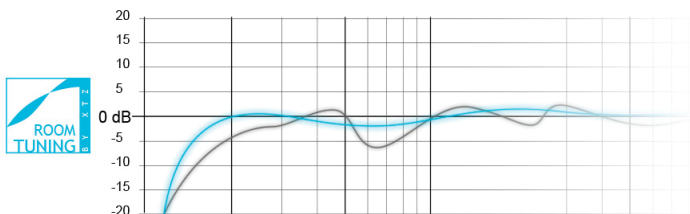

## SPECIFICATION

<b>TYPE</b>	Active 2 way speaker   1" Dome tweeter + waveguide   4.5" High power Woofer
<b>AMPLIFIER</b>	2 x 50 Watts (Class D)
<b>ENCLOSURE</b>	Bass reflex tuned for lower bass response alternative Sealed Enclosure
<b>FREQUENCY RESPONSE (+/- 3dB)</b>	52 - 30 000 Hz
<b>SIZE</b>	H 252 x W 140 x D 180 (mm)
<b>WEIGHT</b>	6,6 kg (14,6 lb)
<b>INPUTS</b>	Analog 3,5mm stereo   Optical S/PDIF TOSLINK   Bluetooth™ 4.0 with aptX®
<b>OUTPUTS</b>	Subwoofer (Coaxial)   USB Power (DC 5V, 1A)
<b>POWER CONSUMPTION</b>	< 0,5 W Standby
<b>ROOM TUNING</b>	YES, Choose Between Sealed or Bass Reflex Enclosure
<b>BOX CONTENTS</b>	TUNE 4 Left & Right Speaker Aluminum Remote AC Power Cord Speaker Cables With Banana Plugs Optical Cable TOSLINK 3,5mm to 3,5mm Analog Stereo Cable Bass Plugs Regular Rubber feet (Spikes) Long Rubber Spikes

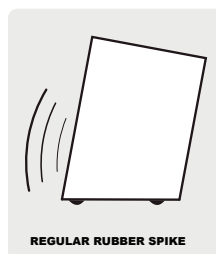
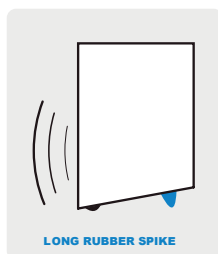

# IMPORTANT SAFETY INSTRUCTIONS



The lightning flash with arrowhead symbol, within an equilateral triangle, is intended to alert the user to the presence of uninsulated "dangerous voltage" within the product's enclosure that may be of sufficient magnitude to constitute a risk of electric shock to persons.

**CAUTION:**  
TO PREVENT THE RISK OF ELECTRIC SHOCK, DO NOT REMOVE COVER (OR BACK). NO USER SERVICEABLE PARTS INSIDE. REFER SERVICING TO QUALIFIED SERVICE PERSONNEL.

The exclamation point symbol, within an equilateral triangle, is intended to alert the user to the presence of important operating and maintenance (servicing) instructions in the literature accompanying the product.

1. **READ INSTRUCTIONS** - All safety and operating instructions should be read before this product is operated.
2. **RETAIN INSTRUCTIONS** - The safety and operating instructions should be retained for future reference.
3. **HEED WARNINGS** - All warnings on this product and in the operating instructions should be adhered to.
4. **FOLLOW INSTRUCTIONS** - All operating and use instructions should be followed.
5. **WATER & MOISTURE** - Do not use this product near water - for example, near a bathtub, washbowl, kitchen sink, laundry, tub, in a wet basement, near a swimming pool, or the like.
6. **ATTACHMENTS** - Do not use any attachments not recommended by the product manufacturer as they may cause hazards.
7. **ACCESSORIES** - Do not place this product on an unstable cart, stand, tripod, bracket, or table. The product may fall, causing serious injury to a child or adult, and serious damage to the product. Use only with accessories recommended by the manufacturer.
8. **WALL or CEILING MOUNTING** - This product should be mounted to a wall or ceiling only as recommended by the manufacturer.
9. **VENTILATION** - This product should be situated so that its location or position does not interfere with its proper ventilation. For example, this product should not be situated on a bed, sofa, rug, or similar surface that may block the ventilation openings; or placed in a built-in installation such as a bookcase or cabinet that may impede the flow of air through the ventilation openings.
10. **HEAT** - This product should be situated away from heat sources such as radiators, heat registers, stoves, or other equipment that produce heat.
11. **POWER SOURCE** - This product should be operated only from the type of power source indicated on the marking label. If you are unsure of the type of power supply to your home, consult your product dealer or local power company.
12. **POWER CORD PROTECTION** - Power-supply cords should be routed so that they are not likely to be walked on or pinched by items placed upon or against them, paying particular attention to cords at plugs, convenience receptacles, and the point at which they exit from the speaker.
13. **CAUTION:** To prevent electric shock, match wide blade of power plug to wide slot of receptacle and fully insert.
14. **OVERLOADING** - Do not overload wall outlets, extension cords, or integral convenience receptacles as this can result in a risk of fire or electric shock.

15. **CLEANING** - This product should be cleaned only as recommended by the manufacturer.
16. **NON-USE PERIODS** - The power cord of the speaker should be unplugged from the outlet when left unused for a long period of time.
17. **OBJECT & LIQUID ENTRY** - Care should be taken so that objects do not fall and liquids are not spilled onto the enclosure.
18. **DAMAGE REQUIRING SERVICE** - The speaker should be serviced by qualified service personnel when:
  - a. The power-supply cord or plug has been damaged.
  - b. Objects have fallen or liquid has been spilled into the speaker.
  - c. The speaker has been exposed to rain.
  - d. The speaker does not appear to operate normally or exhibits a marked change in performance.
  - e. The speaker has been dropped or damaged.
19. **SERVICING** - Do not attempt to service the product yourself, beyond what is described in these operating instructions.
20. **REPLACEMENT PARTS** - When replacement parts are required, be sure the service technician has used replacement parts specified by the manufacturer or have the same characteristics as the original part. Unauthorized substitutions may result in fire, electric shock, or other hazards.
21. **SAFETY CHECK** - Upon completion of any service or service of repairs to this product, ask the service technician to perform safety checks to determine that the product is in proper operating condition. All other servicing should be referred to qualified service personnel.

## THANK YOU FOR YOUR PURCHASE

A DIGITAL VERSION OF THIS **QUICK START GUIDE** AND **MORE INFO** CAN BE FOUND AT:

# XTZ.SE

